



# THE MOORINGS

*Built by Beneteau to Moorings Specifications*

**50.5**

*5 cabins - 5 heads*

*Innovative, spacious, bright, and sophisticated only begins to describe the exciting Moorings 50.5. Built by Beneteau, she features a sleek coach roof, long side windows, a fully-integrated mainsail arch and all the ergonomic ease of detailed design to make the most of each area.*

*Fitted with 4 cabins and 4 electric heads, plus bow cabin with berth and head, large saloon and linear port side galley, the Moorings 50.5 offers an abundance of interior space. Her massive cockpit, foredeck and dual helm makes her comfortable outside as well. Air conditioner, generator, bow thruster, electric winches, and upgraded electronics result in a yacht that's not only fun to relax aboard but a joy to sail as well. All in all, the Moorings 50.5 is thoroughly immersed in modern design, technology and style.*

  
**The Moorings®**  
YACHT OWNERSHIP

## HULL & DECK

Design made following European Directive requirements and according to EC certification Monolithic hull design in polyester

Monolithic structural counter moulding laminated and bonded to the hull

Deck in balsa and glass fibre sandwich covered in diamond point type nonslip surface

Deck hull joint bonded and screwed, with 1 solid wood toe rail

Cast iron keel fixed with bolts and stainless steel backing plates

Rudder hung with glass compound stock

White hull and deck with Moorings striping and graphics

## COCKPIT

Self-draining cockpit

GRP cockpit table - 2 flaps - glove boxes - central bottle holder - bottle holder on reverse side

12 v socket - lamp with shade

GRP cockpit benches

2 x Cockpit lockers

Locker under helm seating to starboard

Gas locker with 2 bottles under port helm seat

Wet locker in cockpit bottom

2 x Steering wheel consoles

Leather covered stainless steel steering wheels - 900 mm diameter

Rudder systems on partition

Metal cable transmission system

Stainless steel guard rail

Navigation instrument stand

Access to emergency tiller system

Emergency tiller

2 x Steering compass on binnacle

Engine throttle and control panel to starboard

2 x Waterproof loudspeakers

Cockpit lighting embedded in fixed arch

2 x Solid wood companionway door on hinges - Sliding hatch made of plexiglass

Bimini and Dodger

## MOORING AND ANCHORING

Self-bailing chain locker - Clench bolt - Hatch cover

Stainless steel bow fitting, 2 rollers

12 v - 1500 w Vertical electrical windlass with remote control wired direct

6 x Aluminium mooring cleats - Stainless steel protection against line chafe

## SAFETY

Open stainless steel bow pulpit

2 x Stainless steel aft push pits

Lifebuoy bracket

Outboard engine bracket

Flag pole socket

Double guardrail and stainless steel stanchions - Opening to port and to starboard in guardrail

2 x Stainless steel handrails on deck

2 x Stainless steel handrails on fixed arch

## SWIM PLATFORM & TRANSOM

Access door pivoted on pantograph (Patented)

Cased life-raft locker in upper stern - 2 doors

Stainless steel swimming ladder with stainless steel protection

Hot and cold cockpit shower

Transom protection

## DECK EQUIPMENT (RIGGING)

Mast ZSPAR 9/10 electro-polished aluminium double spreader stepped on the deck

Anodised aluminium boom

Discontinuous stainless steel standing rigging

Single backstay with turnbuckle

Rigid boom vang

Genoa furling system with drum on the deck

2 x Blocks "Stand up" on mainsheet arch

2 x Genoa tracks with piston adjusted traveller cars - 2 Genoa sheet return blocks

Rigging run back to cockpit (except boom topping lift)

Complete running rigging:

Main halyard

Genoa halyard with clutch on mast and cleat

Boom topping lift with cleat on mast

Mainsheet

2 x Genoa sheets

2 x Jiffy reefing lines

Manual reef

11 x Jammers

6 x Jamming cleats

## WINCHES

2 x Electric genoa sheet winches

Electric halyard sheet winch

2 x Self tailing manoeuvring winches (H46.2 STC)

2 x Aluminium winch handles

2 x Winch handle holders

## SAILS

Heavy duty charter spec furling genoa with anti-UV protection strip.

Heavy duty charter spec classic mainsail with Moorings logo, full batten with low-friction slides and cars.

Heavy duty charter spec lazy jack and stack pack system in Moorings colours and Moorings logo.

## ENGINE

Engine: Yanmar Diesel 110 hp

Engine control panel in cockpit

Engine compartment: Foam soundproofing - Ventilation: 1 air intake and 1 pressurized air outlet

Alternator 12 v / 80 Ah

2 x Rotomoulded 53 gal. / 200 l diesel tanks under aft berths

Electronic gauge with low-level alarm

Sea water filter

Racor Fuel filter

Fixed three blade propeller

1 Engine access through companionway (opening with gas piston) - 2 engine access through aft cabins

Bow thruster

## ELECTRICAL SYSTEM

12 v circuit - 110 v or 220 v circuit

2 x house batteries (140 Ah)

2 x additional house battery (140 Ah)

Engine start battery (110 Ah)

40 Ah Battery charger, 110 v or 220 v shore power, charge divider

Additional 40 Ah battery charger

Electrical panel (12 v / 110 v or 220 v) (Circuit breakers - Voltmeter - Water gauge - fuel gauge - battery warning - fuel warning)

12 v Socket - 8 x 110 v or 220 v Sockets

LED Lighting: Halogen ceiling lights, reading lights, background lighting, white/red light fitting

LED Navigation lights: Navigation light(s) fore and aft navigation light / spreader light forward of mast  
1 Mooring light on masthead  
1 Deck light

2 x multifunction display

Electronic depth and speed reading SOG from the GPS

Electronic wind speed and direction.

Chart plotter with GPS.

Hydraulic linear drive autopilot

Wire runs for options cables

Shore power wired direct

Air conditioning unit  
Saloon: 16,000 BTU  
Fwd Cabin: 8000 BTU  
Aft Cabin: 12000 BTU

7.5KVA Generator

Cockpit speakers

Fans in cabins & saloon

# SPECIFICATIONS

TV/DVD	Panoramic windows with pleated blinds	<b>NAVIGATION STATION</b> Control console with flap - glove boxes - storage - moulded wood beading	21 gallon (80 l) rigid holding tank	1 Opening porthole with curtain
TV bracket & electrical supply inverter	3 Hull portholes with curtain	Navigation seat with cushion	Polyester washbasin with mixer tap	1 Porthole opening onto cockpit with curtain
VHF at chart table	1 Fitted deck house side window with curtain	Drawer	Hot and cold shower with grey water sump and electric pump for outboard discharge	1 Opening deck hatch with blind / mosquito nets
Speaker for VHF in cockpit.	2 Opening deck hatches with blind / mosquito nets	Hinged electrical panel enabling access to electrical connections	Mirrors	Door access to bathrooms
Radio/CD/MP3 unit	Leather covered stainless steel handrail in front of forward cabin	Navigation instrument panel (without instruments)	Toilet accessories: glass holder, soap tray, towel rail, bin, paper dispenser	Marine mattress
2 x Interior speakers	Indirect lighting	Radio CD player / Stereo MP3 - 2 stereo speakers	Cupboard and cubby hole	<b>BOW CABIN</b> Air conditioned
<b>WATER SYSTEM</b> 3 Rotomoulded freshwater tanks: 2 x 86 gallon (325 l) in the saloon 1 x 87 gallon (330 l) forward 259 gallon (980 l) total capacity:	<b>GALLEY</b> Linear kitchen	<b>AFT HEADS</b> Headroom: 6'9" (2.07 m)	1 Opening porthole with curtain	Access through deck hatch - Stainless steel ladder
3 x Deck fillers - tank selection with ¼ by-pass valves	Laminated work top	Large electric marine toilet	<b>FORE CABINS</b> Symmetrical cabins each one consisting of: Headroom: 6'7" (2.00 m)	1 Fold-down couchette (6'3" x 2' / 1.92 m x 0.63 m)
Pressurised electric water pump Accumulator tank - In line filter	Stainless steel sink 2 rectangular basins - cutting board	21 gallon (80 l) rigid holding tank	Central double bed, marine mattress (6'7" x 4'10" x 3' / 2.00 m x 1.47 m x 0.85 m)	Foam mattress
10 gallon (40 l) electric water heater	Mixer tap cold water / hot	Polyester washbasin with mixer tap	Hanging locker, Cubby hole lockers, Drawer	Basin - washbasin - mixer tap
2 x 21 gallon (80 l) rigid holding tank (Port forward + Starboard aft)	3 burner gas stove and stainless steel oven on mountings, Stainless steel protection handrail	Hot and cold shower with grey water sump and electric pump for outboard discharge	1 Mirror on forward bulkhead	1 manual marine toilet
Electrical shower drain pumps	Microwave oven	Mirrors	1 Mirror Gateway	Blind / mosquito net
2 x Electric bilge pump with float switch	34 gal. (130 l), 12 v refrigeration unit, top opening	Toilet accessories: glass holder, soap tray, towel rail, bin, paper dispenser	1 Hull porthole with curtain	<b>ADDITIONAL GEAR</b> Mosquito screens for opening hatches
Manual bilge pump	26 gal. (100 l) ice box, 12 v refrigeration unit, top opening	Cupboard and cubby hole	1 Opening deck hatch with shutter / mosquito nets	Bedding, linens and galley equipment.
Electric ice box drain pump	Cupboards, Drawers, Cubby hole lockers	1 Opening porthole with curtain	Marine mattress	Safety gear
<b>GAS SYSTEM</b> Box for 2 gas bottle(s) in cockpit	Fitted cupboards and lockers (shelves, tea towel holder, bin)	<b>COMPANIONWAY</b> Headroom: 6'10" (2.08 m)	<b>AFT CABINS</b> 2 Symmetrical cabins each one consisting of: Headroom: 6'4" (1.95 m)	
Pressure reducing valve and safety tap	Storage space with stainless steel pull-out with bottle holder	Formica companionway with steps in moulded wood with nonslip surface	Double bed (6'8" x 4'9" x 3'3" / 2.05 m x 1.46 m x 1.00 m)	
<b>SALOON</b> Headroom: 6'8" (2.05 m)	Hull porthole with curtain	2 x guard rails	Marine mattress	
U-shaped saloon bench, central bench seat, double density foam	Fixed deck house side window with concertina blind	<b>FORWARD HEADS</b> 2 Symmetrical washrooms, private access from cabins, each with: Headroom: 6'5" (1.96 m)	Hanging locker, lockers and cubby holes	
Saloon table with cushions	2 x Opening portholes on coaming in side windows to port	Large electric marine toilet	1 Mirror	
Salon table converts to double berth (cushions included)			1 Hull porthole with curtain	
Cupboards, cubby hole lockers and storage along the hull, Storage under bench seats				

# THE MOORINGS

*Built by Beneteau to Moorings Specifications*

## 50.5

*5 cabins - 5 heads*

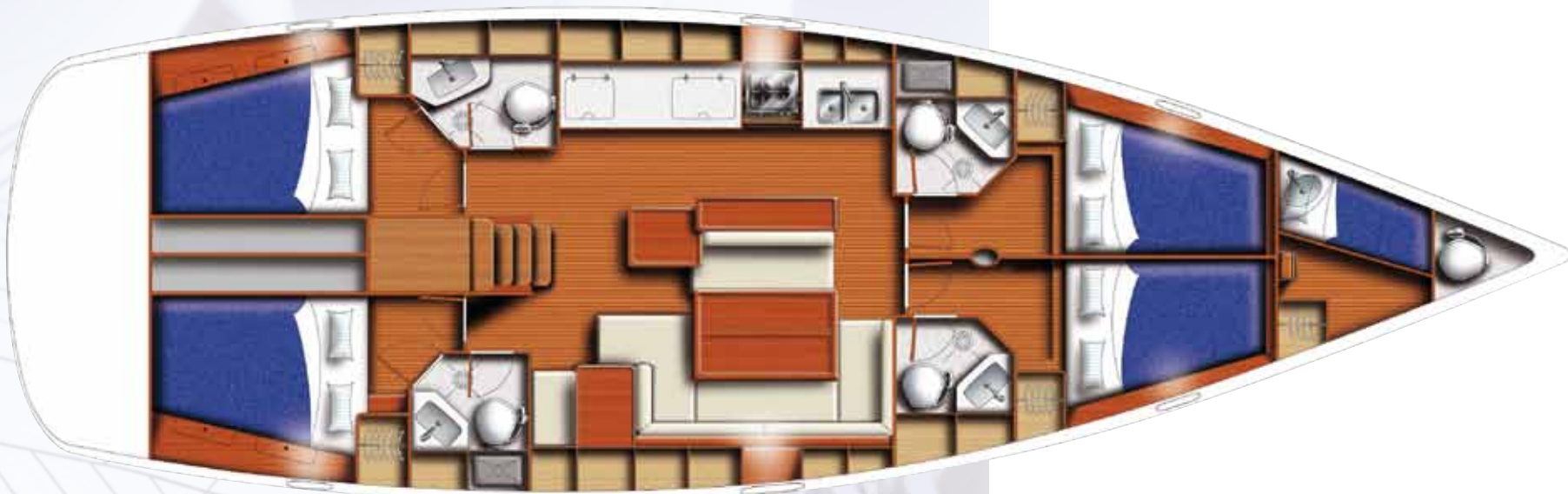

### **Technical Information**

Length Overall	50 ft 7 in. / 15.42 m	Fuel Capacity	105 gal. / 400 l
Hull Length	49 ft 1 in. / 14.98 m	Water Capacity	259 gal. / 980 l
Beam	15 ft 10 in. / 4.82 m	Berths	4 + 1 in bow
Draft	6 ft 6 in. / 2 m	Displacement	27,954 lbs / 12,680 kg
Sail Area	1268 sq ft / 117 sq m	Heads	5
Auxiliary Power	110 hp	Showers	6

**The Moorings**<sup>®</sup>  
YACHT OWNERSHIP